

County of Kane
Office of County Board
Kane County Government Center

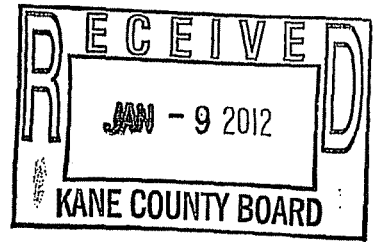

Karen McConnaughay
Chairman
630-232-5930



719 Batavia Avenue
Geneva, Illinois 60134
Fax 630-232-9188

DOCUMENT VET SHEET
for
Karen McConnaughay
Chairman, Kane County Board

Name of Document: Amendment to an Intergovernmental Agreement w/IDOT for Phase II Engineering & Supplemental Appropriation for Big Timber Road over Pingree & Tyler Creeks, Kane Co. Sec. No. 06-00345-00-CH

Submitted by: Linda Haines

Date Submitted: _____, 2011

Examined by: Pat Jaeger
(Print name)

(Signature)

11-14, 2011
(Date)

Post on Web: Yes No Atty. Initials

Comments:

Chairman signed: Yes No 1/10/2012
(Date)

Document returned to: Linda Haines



Illinois Department of Transportation

Local Agency: County of Kane; State Contract: []; Day Labor: []; Local Contract: [X]; RR Force Account: []

Local Agency Amendment # 1 for Federal Participation

Section: 01-00266-00-BR; Fund Type: HBP; ITEP Number:

Table with columns for Construction, Engineering, and Right-of-Way, each with Job Number and Project Number.

This Amendment is made and entered into between the above local agency hereinafter referred to as the "LA" and the state of Illinois, acting by and through its Department of Transportation, hereinafter referred to as "STATE".

BE IT MUTUALLY AGREED that all remaining provisions of the original agreement not altered by this Amendment shall remain in full force and effect and the Amendment shall be binding upon and inure to the benefit of the parties hereto, their successors and assigns.

Amended Division of Cost

Table showing cost breakdown by Type of Work (Participating Construction, Non-Participating Construction, Preliminary Engineering, etc.) with columns for FHWA, STATE, LA, and Total.

*Maximum FHWA (HBP) Participation 80% Not to Exceed \$283,952.

NOTE: The costs shown in the Division of Cost table are approximate and subject to change. The final LA share is dependent on the final Federal and State participation. If funding is not a percentage of the total, place an asterisk in the space provided for the percentage and explain above. The Federal share of construction engineering may not exceed 15% of the Federal share of the final construction cost.

The LA further agrees, as a condition of payment, that it accepts and will comply with the applicable provisions set forth in this Agreement and all exhibits indicated above.

APPROVED

Local Agency

APPROVED

State of Illinois Department of Transportation

Karen McConnaughay

Name of Official (Print or Type Name)

Ann L. Schneider, Secretary of Transportation

Date

County Board Chairman

Title (County Board Chairperson/Mayor/Village President/etc.)

By:

(Delegate's Signature)

Handwritten signature of Karen McConnaughay and date 11/10/12

(Delegate's Name - Printed)

The above signature certifies the agency's TIN number is 36-6006585 conducting business as a Governmental Entity.

DUNS Number 945248565

William R. Frey, Interim Director of Highways

Date

Ellen J. Schanzle-Haskins, Chief Counsel

Date

NOTE: If signature is by an APPOINTED official, a resolution authorizing said appointed official to execute this agreement is required.

Matthew R. Hughes, Acting Director of Finance and Administration Date

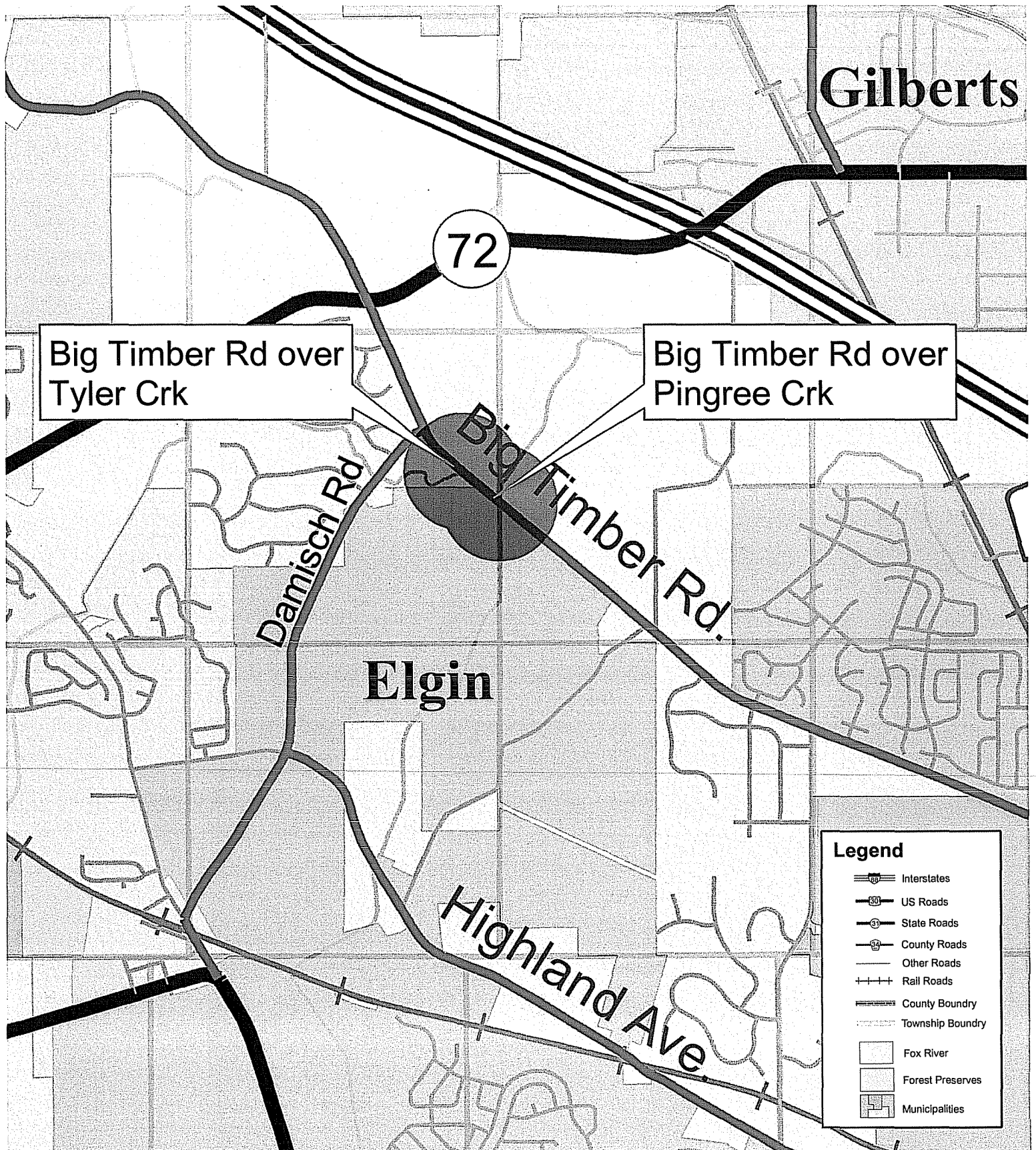

Big Timber Rd over Tyler Crk

Big Timber Rd over Pingree Crk

Gilberts

72

Elgin

Legend

- Interstates
- US Roads
- State Roads
- County Roads
- Other Roads
- Rail Roads
- County Boundary
- Township Boundary
- Fox River
- Forest Preserves
- Municipalities

Section Number 01-00266-00-BR
 Big Timber Road over Tyler & Pingree Creeks

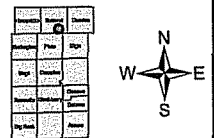
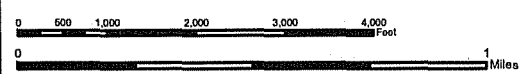

KANE COUNTY
Division of Transportation